



Ledger Marine

CHARTERS

1500 Westlake Avenue North
Seattle, Washington 98109

(206) 283-6160

www.ledgermarinecharters.com

**48 Foot
Cockpit Motor
Yacht**

Floating Island

Prime Season Rate/Week **\$4,000.00**
(Other season rates available)



MANUFACTURER: Tollycraft
YEAR BUILT: 1979
STYLE: Cockpit Motor Yacht
MASTER STATEROOM: KING ensuite w/head
OTHER STATEROOMS: Twin V berths ensuite w/head
SLEEPS TOTAL: Six (Sofa converts for two in salon)
HEADS: Two
BATH/SHOWERS: One stall shower, one wand shower
CREW QUARTERS: None
ENGINE(S): Twin GM 6-71 Diesel
AUXILIARY POWER: KOHLER 12 KW Generator; Heart Inverter
CRUISE SPEED: 12 knots
MAX SPEED: 14 knots
HEAT/AIR COND.: Espar Forced Air, Diesel Heat
OVERALL LENGTH: 48 Feet, 2 inches
BEAM: 15 feet, 2 inches
DRAFT: 4 feet, 0 inches
DISPLACEMENT: 42,000 pounds
HULL/TYPE: Fiberglass/Semi-Displacement
FUEL CAPACITY: 600 gallons
WATER CAPACITY: 188 gallons
WASTE CAPACITY: 98 gallons
TENDER: Boston Whaler 11 foot
TENDER POWER: 25 HP Mercury O/B

Accommodations and Special Features

Built in 1979 in Kelso, Washington, this Tollycraft became one of 80 yachts built between 1976 and 1985; and this series of yachts was considered the most sea-worthy of any yacht in its class, in its time. And comforts were far ahead of the time as well. Floating Island has had the fine touch of a loving owner for nearly 30 years, and the comforts echo their desires. The master stateroom was converted from a queen bed to a full KING. Diesel heat system was added as well as additional features in the galley, including the dishwasher. And the electronics were always up to date, and extensive. The forward stateroom provides excellent guest comforts including the ensuite head, each head features electric Sani-flush toilets. The stall shower in the master stateroom is large and comfortable. The salon has two helm chairs that adjust to cruising height, or can be lowered and turned to become part of a large salon. The dinette below is comfortable, and the salon cocktail table doubles for entertaining as well as meals. And the bridge deck provides everyone with a beautiful area for enjoying the beauty of the great northwest.

ELECTRONICS

VHF Radio(s) Icom, Horizon
 Depth Sounder 1 Datamarine Digital
 Depth Sounder 2 Furuno
 GPS: Portable Garmin
 Plotter: Garmin
 Auto Pilot Wesmar
 Radar: Furuno 36 mile
 Salon Entertain: AM-FM-CD
 32 inch plasma TV

Master Stateroom: Plasma Television

Additional: Wind Direction, and
 wind velocity meters
 National Radio Haler
 CB Transceiver
 Steering Rudder Meter
 Radio Direction Finder

Mechanical

Engine(s): (2) 6-71, 285 HP Dsl
 Generator: Kohler 12 KW Dsl
 Inverter: Heart 2 KW
 Batteries: Twin Banks, select
 (5) LA Marine total
 (2) 12 volt DC
 Charger: (2) 12 volt DC
 Shore Power: 125 volt
 Shore Cable: (2) 50' 30 amp
 Heat: Espar Forced Air
 A/C: None
 Water System: Paragon w/pump tank
 AC Power Sys: At helm, each circuit
 with magnetic break
 DC Power Sys: At helm, all circuits
 w/magnetic breaker
 Windlass: 12 volt electric
 Davit: 12 volt electric on
 house top
 Washer/Dryer: None
 Dishwasher: 110 volt/compact

Deck and Hull Features:

Designed by Ed Monk, this yacht starts with a solid fiberglass semi-displacement hull, with rounded chines and a long keel. The fiberglass walk around and decks are practical and very durable; the top decks include the cabin top with electric davit, and the bridge deck with the second helm, and enough seating for most everyone. A Naval anchor with 300 feet of Chain is controlled with an electric windlass. Access to the cabin include a cockpit door to the master stateroom, plus salon doors port and starboard. All cleats and chocks are stainless steel, and the full walk around gunwale provides teak capped stainless welded rails. The list keeps going with obvious pride from the owners.

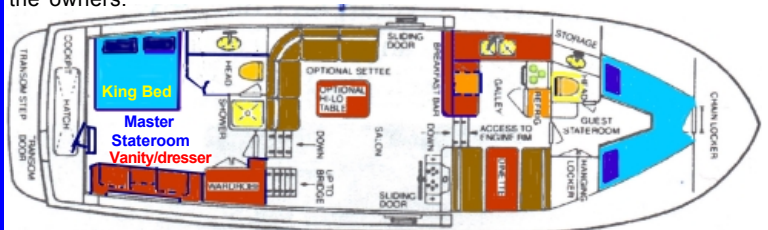

(All information believed to be accurate, but not guaranteed)



The Staterooms are shown above, with the King master ensuite upper left, the master head below, and the valet and storage cabinets center top and dresser and vanity at right top.

The guest ensuite cabin forward provides V-berths, with storage below, additional storage just left of the entry, and the guest ensuite head shown left of the V-berth.

The galley above and right features a Princess stove and oven, Norcold refrigerator/freezer, and dishwasher. Storage is excellent, and all small amenities are provided.

The master helm with electrical panel, and all electronics are shown to the right.

